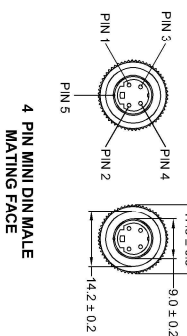
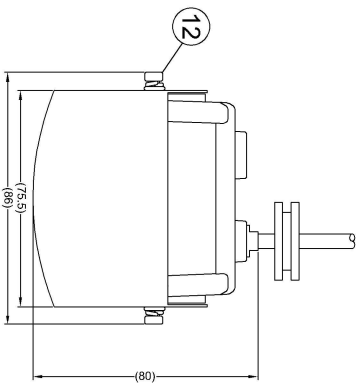

TABLE 1: BE-8XXC/2XXC CAMERA KIT OPTIONS

PART NO.	MODEL NO.	DESCRIPTION
1623E	BE-800C	CAMERA, ELITE, HEATED, ULTRA-LOW-LIGHT, PAL
1559D	BE-800C(40)	CAMERA, ELITE, HEATED, ULTRA-LOW-LIGHT, PAL, 40°
1426D	BE-800C(78)	CAMERA, ELITE, HEATED, ULTRA-LOW-LIGHT, PAL, 78°
1905D	BE-801C	CAMERA, ELITE, HEATED, ULTRA-LOW-LIGHT, NTSC
2085C	BE-801C(40)	CAMERA, ELITE, HEATED, ULTRA-LOW-LIGHT, NTSC, 40°
2084C	BE-801C(78)	CAMERA, ELITE, HEATED, ULTRA-LOW-LIGHT, NTSC, 78°
4924B	BE-850C	CAMERA, ELITE, HEATED, ULTRA-LOW-LIGHT, PAL, 12.24VDC
1624B	BE-200C	CAMERA, ELITE, HEATED, ULTRA-LOW-LIGHT, PAL, BLACK AND WHITE



PIN #	WIRE COLOUR	DESCRIPTION
1	YELLOW	VIDEO
2	RED	+12V
3	BLUE	N.C
4	WHITE	AUDIO
5	BLACK/SHIELD	GND

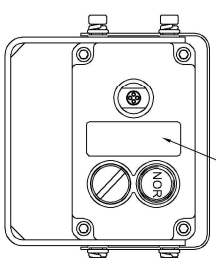
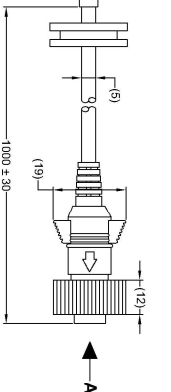
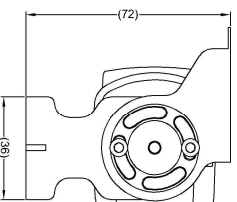
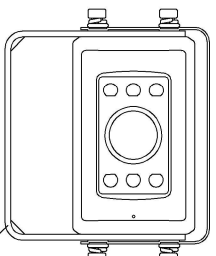
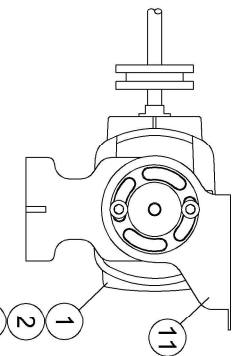
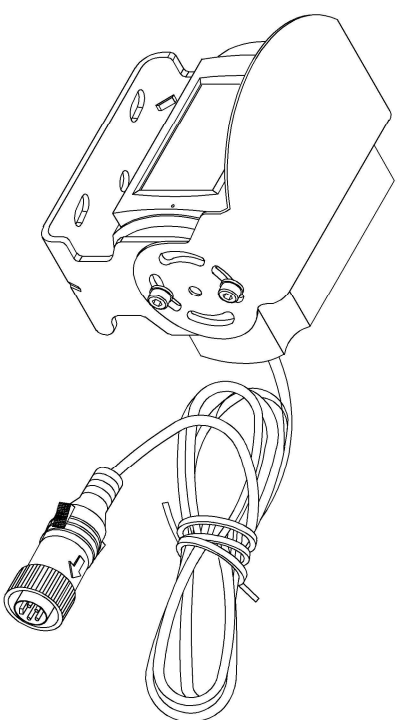

TABLE 2: CAMERA KIT CONTENTS

ITEM	①	②	③	④	⑤	⑥	⑦	⑧	⑨	⑩	⑪	⑫
PART NO.	3243E	3481C	3482C	4411C	3502B	3502B	49373	3490A	3247C	3244A	3245	3246
MODEL NO.	BE-800C-C	BE-800C(40)-C	BE-800C(78)-C	BE-801C-C	BE-801(40)-C	BE-801(78)-C	BE-850C-C	BE-200C-C	BE-8XXC/BE-2XXC-IG	BE-89XC/BE-XC-SERIES	BE-89XC/BE-XC-SERIES	BE-89XC/BE-XC-SERIES
DESCRIPTION	CAMERA, HEATED, PAL	CAMERA, HEATED, PAL, 40°	CAMERA, HEATED, PAL, 78°	CAMERA, HEATED, NTSC	CAMERA, HEATED, NTSC, 40°	CAMERA, HEATED, NTSC, 78°	CAMERA, HEATED, PAL, 12.24VDC	CAMERA, HEATED, PAL, BLACK AND WHITE	BE-8XXC/BE-2XXC-IG	BE-89XC/BE-XC-SERIES	BE-89XC/BE-XC-SERIES	BE-89XC/BE-2XXC-IG
QTY.	1	1	1	1	1	1	1	1	1	1	1	1

NOTES:

1. REFER TO COMPONENT DRAWINGS FOR COMPONENT DETAILS.
2. FOR PRODUCT LABEL AND PACKAGING DETAILS REFER TO MASTER BOM.
3. FOR INSTALLATION DETAILS REFER TO INSTALLATION GUIDE.
4. ANY CUSTOMER MODIFICATION OF THIS PRODUCT CAUSING SUBSEQUENT FAILURE IS NOT A LIABILITY OF BRIGADE ELECTRONICS PLC.

PROPRIETARY NOTICE

THIS DESIGN AND TECHNICAL INFORMATION APPEARING ON THIS DRAWING IS THE PROPERTY OF BRIGADE ELECTRONICS, AND IS DISCLOSED IN CONFIDENCE. IT IS NOT TO BE COPIED, REPRODUCED, REVEALED TO OR EXPLOITED BY OTHERS, EITHER IN WHOLE OR IN PART WITHOUT THE EXPRESS WRITTEN CONSENT OF BRIGADE ELECTRONICS.

Revision Notes:	RT - TABLE 2 UP DATED TO REMOVE REFERENCE TO THE BE-8XXC/BE-2XXC-IG (3247B) AS PER CR-A158
Drawn:	GOVENDER
Checked:	KEBEDE
Approved:	SLAVER
Date:	04/11/20

BRIGADE
www.brigade-electronics.com

Assembly Pl Approval	Approved by	Checked by	Drawn by
TCHOI	SLAVER	JTYRRELL	SGOVENDER
Angle of Projection	Units	Scale	Released
Third Angle	mm	N/A	21/09/20
Status	Released	Assembly Ref	
RELEASED			
Part No	SEE TABLE 1	BE-8XXC.2XXC	
		BE-004424-01-20	